



* required information

Section 1 of 18

You can save the form at any time and resume it later. You do not need to be logged in when you resume.

System reference This is the unique reference for this application generated by the system.

Your reference You can put what you want here to help you track applications if you make lots of them. It is passed to the authority.

Are you an agent acting on behalf of the applicant?

Yes No

Put "no" if you are applying on your own behalf or on behalf of a business you own or work for.

Applicant Details

* First name

* Family name

* E-mail

Main telephone number Include country code.

Other telephone number

Indicate here if the applicant would prefer not to be contacted by telephone

Is the applicant:

Applying as a business or organisation, including as a sole trader

Applying as an individual

A sole trader is a business owned by one person without any special legal structure. Applying as an individual means the applicant is applying so the applicant can be employed, or for some other personal reason, such as following a hobby.

Applicant Business

Is the applicant's business registered in the UK with Companies House? Yes No

Note: completing the Applicant Business section is optional in this form.

Registration number

Business name If the applicant's business is registered, use its registered name.

VAT number Put "none" if the applicant is not registered for VAT.

Legal status

Continued from previous page...

Applicant's position in the business

Home country

The country where the applicant's headquarters are.

Registered Address

Address registered with Companies House.

Building number or name

Street

District

City or town

County or administrative area

Postcode

Country

Agent Details

* First name

* Family name

* E-mail

Main telephone number

Include country code.

Other telephone number

Indicate here if you would prefer not to be contacted by telephone

Are you:

- An agent that is a business or organisation, including a sole trader
- A private individual acting as an agent

A sole trader is a business owned by one person without any special legal structure.

Agent Business

Is your business registered in the UK with Companies House? Yes No

Note: completing the Applicant Business section is optional in this form.

Registration number

Business name

If your business is registered, use its registered name.

VAT number

Put "none" if you are not registered for VAT.

Legal status

Continued from previous page...

Your position in the business OPERATIONS MANAGER

Home country United Kingdom

The country where the headquarters of your business is located.

Agent Registered Address

Address registered with Companies House.

Building number or name LOCKETT HOUSE

Street [REDACTED]

District

City or town KIDDERMINSTER

County or administrative area

Postcode DY10 2AH

Country United Kingdom

Section 2 of 18

APPLICATION DETAILS

This application cannot be used to vary the licence so as to extend the period for which the licence has effect or to vary substantially the premises to which it relates. If you wish to make that type of change to the premises licence, you should make a new premises licence application under section 17 of the Licensing Act 2003.

I/we, as named in section 1, being the premises licence holder, apply to vary a premises licence under section 34 of the Licensing Act 2003 for the premises described in section 2 below.

* Premises Licence Number LN/201700125

Are you able to provide a postal address, OS map reference or description of the premises?

Address OS map reference Description

Postal Address Of Premises

Building number or name WEST CLIFF ROAD SERVICE STATION

Street 5-7 WEST CLIFF ROAD

District

City or town RAMSGATE

County or administrative area KENT

Postcode CT11 9JW

Country United Kingdom

Premises Contact Details

Telephone number

Continued from previous page...

Non-domestic rateable
value of premises (£)

Section 3 of 18

VARIATION

Do you want the proposed
variation to have effect as
soon as possible? Yes No

Do you want the proposed variation to have effect in relation to the
introduction of the late night levy?

Yes No

You do not have to pay a fee if the only
purpose of the variation for which you are
applying is to avoid becoming liable to the
late night levy.

If your proposed variation
would mean that 5,000 or
more people are expected to
attend the premises at any
one time, state the number
expected to attend

Describe Briefly The Nature Of The Proposed Variation

Describe the premises. For example the type of premises, its general situation and layout and any other information which could be relevant to the licensing objectives. Where your application includes off-supplies of alcohol and you intend to provide a place for consumption of these off-supplies, you must include a description of where the place will be and its proximity to the premises.

1. INCREASE BOTH THE OPENING HOURS OF THE PREMISES AND THE ALCOHOL OFF SALES HOURS FROM 06:00-23:00 DAILY, TO 00:00-24:00 (24 HOURS) DAILY.
2. ADD THE PROVISION OF LATE NIGHT REFRESHMENT FROM 23:00 TO 05:00 DAILY TO THE PREMISES LICENCE.
3. AMEND CONDITION 2 UNDER ANNEX 2 OF THE PREMISES LICENCE TO READ 'FROM 05:00-23:00 HOURS, THERE SHALL BE MORE THAN ONE MEMBER OF STAFF PRESENT ON THE PREMISES AT ANY GIVEN TIME.'
4. ADD THE FOLLOWING CONDITIONS TO THE PREMISES LICENCE:
- FROM THE HOURS OF 23:00 TO 05:00 THE NEXT DAY, THE SHOP SHALL OPERATE A CLOSED DOOR POLICY WITH ALL SERVICE TAKING PLACE VIA THE NIGHT HATCH WINDOW ONLY.
5. UPDATE THE NAME OF THE PREMISES FROM 'FAMILY SHOPPER' TO 'WEST CLIFF ROAD SERVICE STATION'. REMOVE TELEPHONE NUMBER LISTED ON THE PREMISES LICENCE.

Section 4 of 18

PROVISION OF PLAYS

See guidance on regulated entertainment

Will the schedule to provide plays be subject to change if this application to vary is successful?

Yes No

Section 5 of 18

PROVISION OF FILMS

Continued from previous page...

See guidance on regulated entertainment

Will the schedule to provide films be subject to change if this application to vary is successful?

Yes No

Section 6 of 18

PROVISION OF INDOOR SPORTING EVENTS

See guidance on regulated entertainment

Will the schedule to provide indoor sporting events be subject to change if this application to vary is successful?

Yes No

Section 7 of 18

PROVISION OF BOXING OR WRESTLING ENTERTAINMENTS

See guidance on regulated entertainment

Will the schedule to provide boxing or wrestling entertainments be subject to change if this application to vary is successful?

Yes No

Section 8 of 18

PROVISION OF LIVE MUSIC

See guidance on regulated entertainment

Will the schedule to provide live music be subject to change if this application to vary is successful?

Yes No

Section 9 of 18

PROVISION OF RECORDED MUSIC

See guidance on regulated entertainment

Will the schedule to provide recorded music be subject to change if this application to vary is successful?

Yes No

Section 10 of 18

PROVISION OF PERFORMANCES OF DANCE

See guidance on regulated entertainment

Will the schedule to provide performances of dance be subject to change if this application to vary is successful?

Yes No

Section 11 of 18

PROVISION OF ANYTHING OF A SIMILAR DESCRIPTION TO LIVE MUSIC, RECORDED MUSIC OR PERFORMANCES OF DANCE

See guidance on regulated entertainment

Continued from previous page...

Will the schedule to provide anything similar to live music, recorded music or performances of dance be subject to change if this application to vary is successful?

Yes

No

Section 12 of 18

PROVISION OF LATE NIGHT REFRESHMENT

Will the schedule to provide late night refreshment be subject to change if this application to vary is successful?

Yes

No

Standard Days And Timings

MONDAY

Start

End

Start

End

Provide timings in 24 hour clock (e.g., 16:00) and only give details for the days of the week when you intend the premises to be used for the activity.

TUESDAY

Start

End

Start

End

WEDNESDAY

Start

End

Start

End

THURSDAY

Start

End

Start

End

FRIDAY

Start

End

Start

End

SATURDAY

Start

End

Start

End

SUNDAY

Start

End

Start

End

Continued from previous page...

Will the provision of late night refreshment take place indoors or outdoors or both?

Indoors Outdoors Both

Where taking place in a building or other structure select as appropriate. Indoors may include a tent.

State type of activity to be authorised, if not already stated, and give relevant further details, for example (but not exclusively) whether or not music will be amplified or unamplified.

THE SALE OF HOT FOOD AND OR HOT DRINKS

State any seasonal variations.

For example (but not exclusively) where the activity will occur on additional days during the summer months.

NONE

Non standard timings. Where the premises will be used for the provision of late night refreshment at different times from those listed above, list below.

For example (but not exclusively), where you wish the activity to go on longer on a particular day e.g. Christmas Eve.

NONE

Section 13 of 18

SUPPLY OF ALCOHOL

Will the schedule to supply alcohol be subject to change if this application to vary is successful?

Yes No

Standard Days And Timings

MONDAY

Start

End

Start

End

TUESDAY

Start

End

Start

End

Provide timings in 24 hour clock (e.g., 16:00) and only give details for the days of the week when you intend the premises to be used for the activity.

Continued from previous page...

WEDNESDAY

Start End
Start End

THURSDAY

Start End
Start End

FRIDAY

Start End
Start End

SATURDAY

Start End
Start End

SUNDAY

Start End
Start End

Will the sale of alcohol be for consumption?

- On the premises Off the premises Both

If the sale of alcohol is for consumption on the premises select on, if the sale of alcohol is for consumption away from the premises select off. If the sale of alcohol is for consumption on the premises and away from the premises select both.

State any seasonal variations.

For example (but not exclusively) where the activity will occur on additional days during the summer months.

NONE

Non-standard timings. Where the premises will be used for the supply of alcohol at different times from those listed above, list below.

For example (but not exclusively), where you wish the activity to go on longer on a particular day e.g. Christmas Eve.

NONE

Section 14 of 18

ADULT ENTERTAINMENT

Continued from previous page...

Highlight any adult entertainment or services, activities, or other entertainment or matters ancillary to the use of the premises that may give rise to concern in respect of children.

Provide information about anything intended to occur at the premises or ancillary to the use of the premises which may give rise to concern in respect of children, regardless of whether you intend children to have access to the premises, for example (but not exclusively) nudity or semi-nudity, films for restricted age groups etc gambling machines etc.

NONE

Section 15 of 18

HOURS PREMISES ARE OPEN TO THE PUBLIC

Standard Days And Timings

MONDAY

Start

End

Start

End

Provide timings in 24 hour clock (e.g., 16:00) and only give details for the days of the week when you intend the premises to be used for the activity.

TUESDAY

Start

End

Start

End

WEDNESDAY

Start

End

Start

End

THURSDAY

Start

End

Start

End

FRIDAY

Start

End

Start

End

SATURDAY

Start

End

Start

End

SUNDAY

Start

End

Start

End

State any seasonal variations.

For example (but not exclusively) where the activity will occur on additional days during the summer months.

Continued from previous page...

NONE

Non standard timings. Where you intend to use the premises to be open to the members and guests at different times from those listed above, list below.

For example (but not exclusively), where you wish the activity to go on longer on a particular day e.g. Christmas Eve.

NONE

Identify those conditions currently imposed on the licence which you believe could be removed as a consequence of the proposed variation you are seeking.

1. THE HOURS WHICH CURRENTLY RESTRICT OPENING AND ALCOHOL SALES TO 06.00-23.00 HOURS EACH DAY.
2. AMENDMENT TO CONDITION 2 UNDER ANNEX 2 OF THE EXISTING PREMISES LICENCE.

- I have enclosed the premises licence
- I have enclosed the relevant part of the premises licence

Reasons why I have failed to enclose the premises licence or relevant part of premises licence.

Section 16 of 18

LICENSING OBJECTIVES

Describe the steps you intend to take to promote the four licensing objectives:

a) General – all four licensing objectives (b,c,d,e)

List here steps you will take to promote all four licensing objectives together.

NONE IN ADDITION TO THOSE ALREADY SHOWN ON THE PREMISES LICENCE OR THOSE WHICH ARE BEING AMENDED OR ADDED TO THE LICENCE AS SET OUT IN SECTION 3 OF THE APPLICATION.

b) The prevention of crime and disorder

NONE IN ADDITION TO THOSE ALREADY SHOWN ON THE PREMISES LICENCE OR THOSE WHICH ARE BEING AMENDED OR ADDED TO THE LICENCE AS SET OUT IN SECTION 3 OF THE APPLICATION.

c) Public safety

Continued from previous page...

NONE IN ADDITION TO THOSE ALREADY SHOWN ON THE PREMISES LICENCE OR THOSE WHICH ARE BEING AMENDED OR ADDED TO THE LICENCE AS SET OUT IN SECTION 3 OF THE APPLICATION.

d) The prevention of public nuisance

NONE IN ADDITION TO THOSE ALREADY SHOWN ON THE PREMISES LICENCE OR THOSE WHICH ARE BEING AMENDED OR ADDED TO THE LICENCE AS SET OUT IN SECTION 3 OF THE APPLICATION.

e) The protection of children from harm

NONE IN ADDITION TO THOSE ALREADY SHOWN ON THE PREMISES LICENCE OR THOSE WHICH ARE BEING AMENDED OR ADDED TO THE LICENCE AS SET OUT IN SECTION 3 OF THE APPLICATION.

Section 17 of 18

NOTES ON REGULATED ENTERTAINMENT

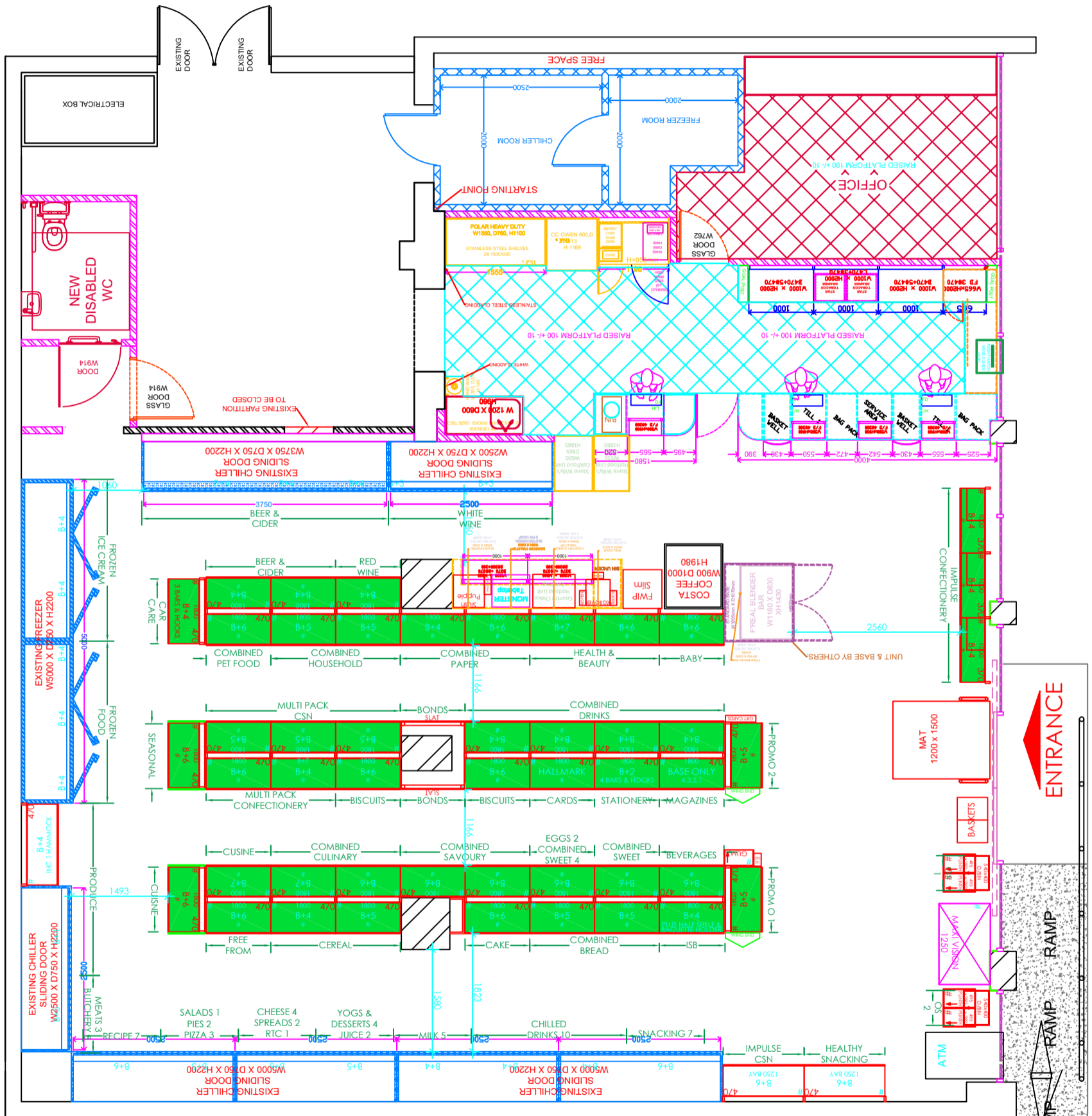

Information contained within this drawing is the sole copyright of Star Filters Ltd and is not to be produced without their express permission. This document must not be copied without written permission and the contents must not be imparted nor be used for any unauthorized purpose.

NOTE

1. ALL THE DIMENSIONS ARE IN MILLIMETERS.
2. ALL THE DIMENSIONS TO BE CHECKED AT SITE.
3. * PRICES NOT INCLUDED (P.NI).

TEXACO

PROJECT:

TEXACO,
5-7 WEST CLIFF ROAD,
RAMSGATE
KENT
CT11 9JW



Unit 3, Polytex work
Wantz Road, Dagenham
Essex, RM10 8PS

Tel: 020 8617 3060
info@starfilters.co.uk
www.starfilters.co.uk

DWG TITLE:

Proposed Floor Plan

DRAWN BY:

J.T

CHECKED BY:

P.P

SCALE:

1:75 @ A3

DWG NO.:

0485 52 102

CLIENT:

Mr. Pratheepan

DATE:

JULY 2020

REVISION:

B